

THESE DRAWINGS AND SPECIFICATIONS ARE THE SOLE PROPERTY OF ADVANCED CONNECTION TECHNOLOGY INC. AND SHALL NOT BE REPRODUCED, COPIED, OR USED IN ANY MANNER WITHOUT THE PRIOR WRITTEN CONSENT OF ADVANCED CONNECTION TECHNOLOGY INC. OR ITS AFFILIATED SUBSIDIARIES.

CAD FILE: XS0411202a

REV.	DESCRIPTION	DWG		APPROVED	
		NAME	DATE	NAME	DATE
X01	PROTOTYPE	penny	2008/02/26	ahua	2008/02/26



- ◆ Assembly dim.
- Functionally dim.
- Control dim.

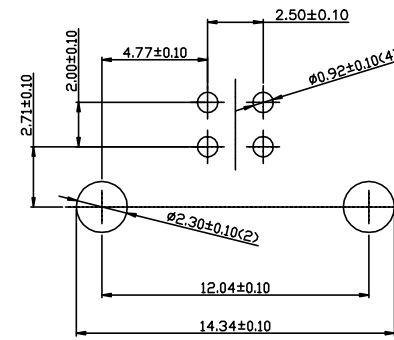
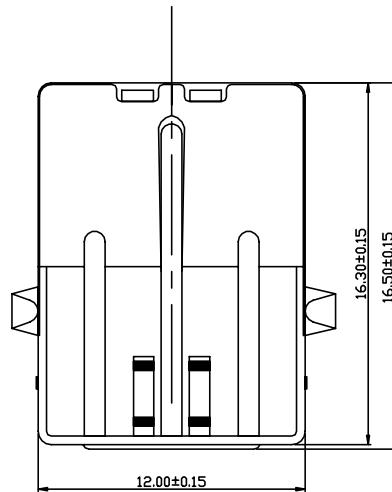
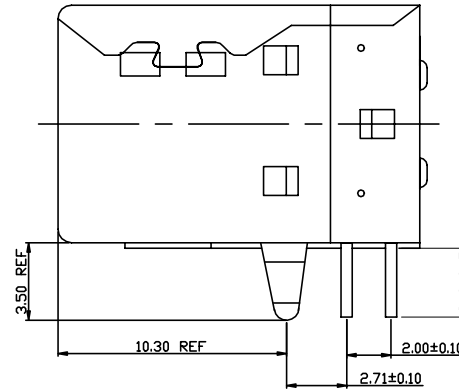
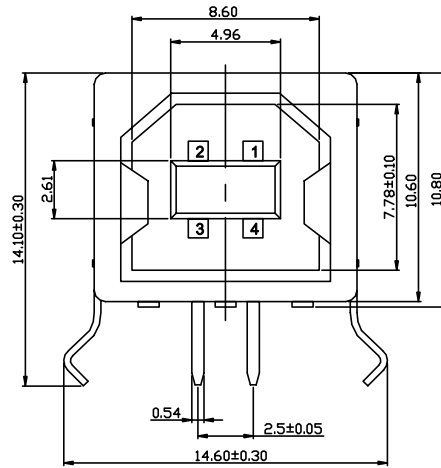

P. C. B. LAYOUT

1. Material:
 - Contacts: Phosphor Bronze
 - Insulator: PBT+30% G.F. UL 94V-0
 - Shell: Brass
 - Back Shell: SPCC
2. Mechanical:
 - Mating Force: 35N max.
 - Withdrawal Force: 10N min.
 - Durability: 1500 cycles min.
3. Electrical:
 - Current: 1.5A
 - Voltage: 30V
 - Withstanding Voltage: 750V AC
 - Contact Resistance: 30mΩ max.
 - Insulation Resistance: 1000MΩ min.
4. Plating:
 - Contacts: Gold Flash And Tin Over
 - Nickel Plated
 - Shell: Nickel over all plating
5. Environmental:
 - Temperature Range: -55°C ~+85°C

INTENDED USE: ACT		Advanced Connection Technology			
GENERAL DIMENSION		TITLE: USB B TYPE		DRAWN: penny 2008/02/26	
XX±0.30	.X±0.20	DWG NO: 301-04112-02		CHECKED: ahua 2008/02/26	
X±0.25	.XX±0.15	REV. X01		APPROVED: hunter 2008/02/26	
UNIT: mm		SCALE: NONE		SHEET 1 OF 1	
		NAME		DATE	