

THESE DRAWINGS AND SPECIFICATIONS ARE THE SOLE PROPERTY OF ADVANCED CONNECTION TECHNOLOGY INC. AND SHALL NOT BE REPRODUCED, COPIED, OR USED IN ANY MANNER WITHOUT THE PRIOR WRITTEN CONSENT OF ADVANCED CONNECTION TECHNOLOGY INC. OR ITS AFFILIATED SUBSIDIARIES.

CAD FILE: XS19001-04a

REV.	DESCRIPTION	DWG		APPROVED	
		NAME	DATE	NAME	DATE
X01	PROTOTYPE	Froos	2008/09/12	Knight	2008/09/12
X02	外購轉自制圖面	Froos	06/01/2009	Knight	06/01/2009

- 1 ■ Functionally dim.
- ◆ Assembly dim.
- Control dim.

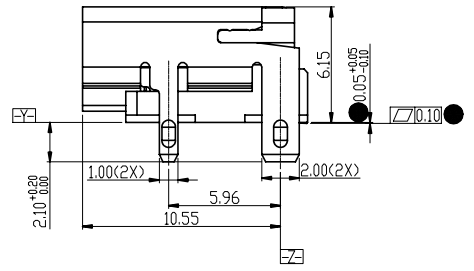
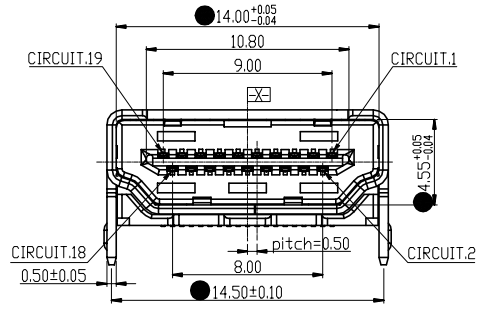
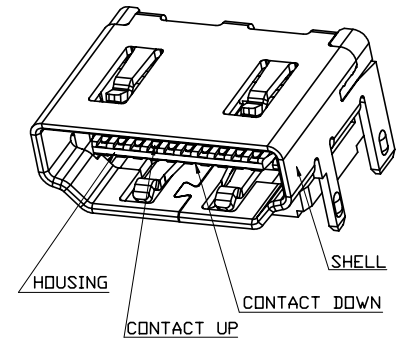
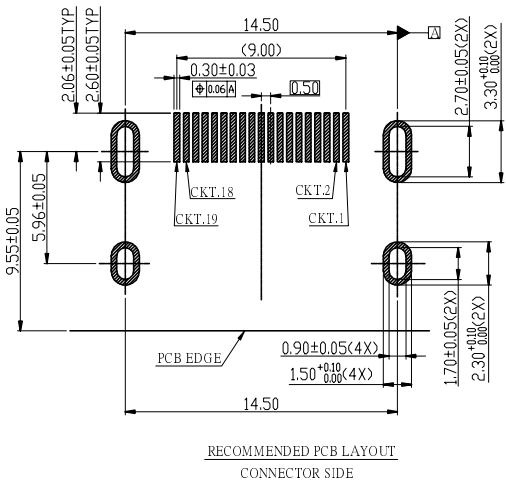
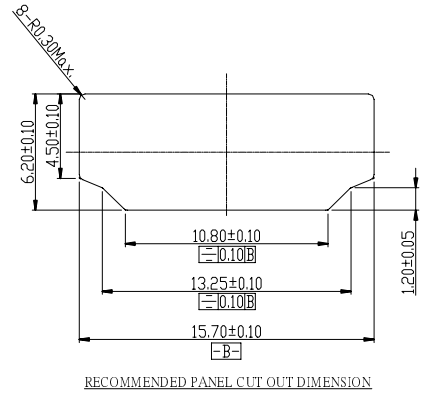
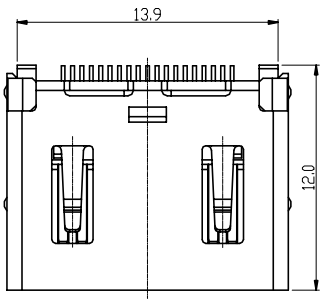

- NOTES:
- MATERIAL:
HOUSING:HIGH TEMPERATURE THERMAL PLASTIC
SHELL:STEEL
TERMINAL:BRASS
 - PLATING:
TERMINAL:CONTACT AREA:GOLD PLATED
SOLDER AREA:TIN PLATED
UNDER PLATE:NICKEL
SHELL:SOLDERABLE NICKEL PLATE OVERALL
 - COPLANARITY IS 0.1mm MAX.

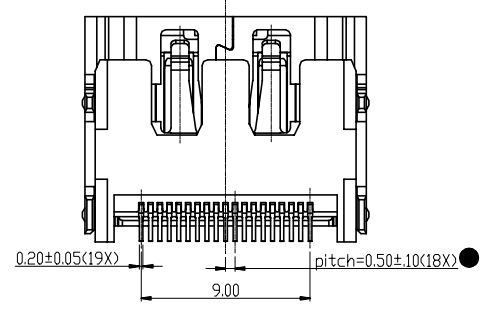

Approval Signature

INTENDED USE: ACT	Advanced Connection Technology TAIWAN TEL: 886-2-88091060			
GENERAL DIMENSION	TITLE: 19Pins HDMI I/O (without flange,with coverback)	DRAWN: Froos	CHECKED: Coco	APPROVED: Knight
X.X±0.15	DWG NO: 350-19001-04	REV: X02	APPROVED: Knight	
X.XX±0.10	UNIT: mm	SCALE: NONE	SHEET: 1 OF 1	NAME DATE